

TWIN SLOT - WALL MOUNTED SHELVING

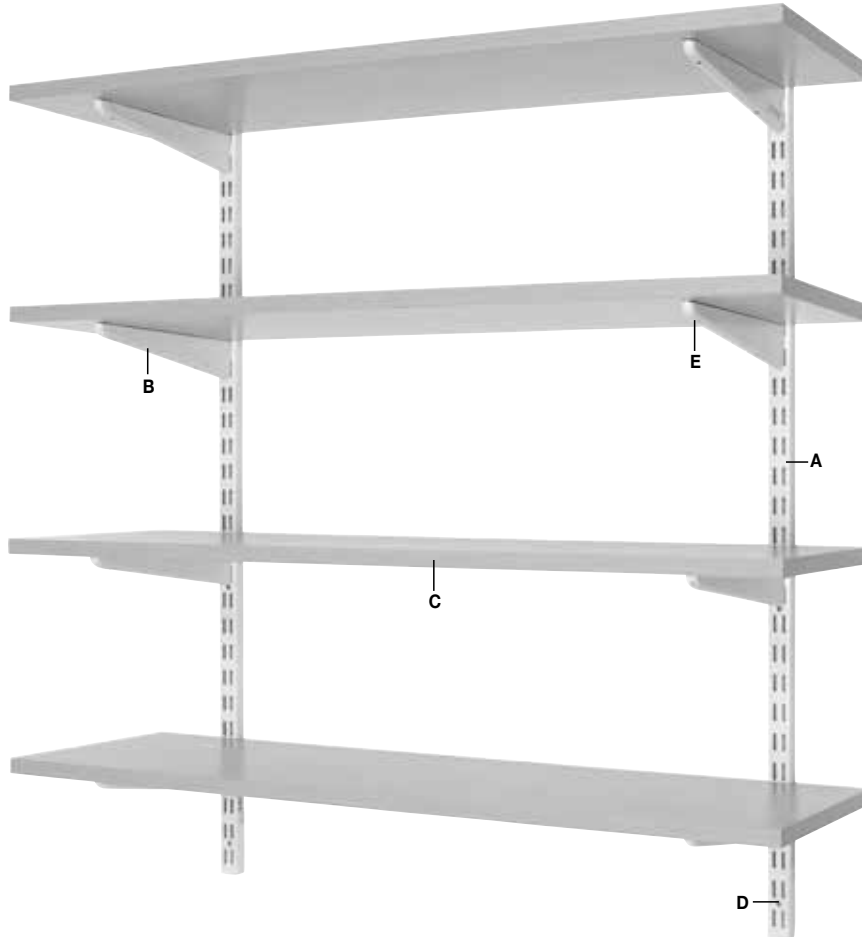

COMPONENTS CHECK LIST:



(A)

SLOTTED STEEL UPRIGHTS
Quantity: 2



(B)

BRACKETS
Quantity: 2 Per Shelf



(C)

SHELVES
Quantity:
Dependant on Kit Choice



(D)

UPRIGHT FIXINGS PACK
Quantity: 1 Pack
(includes: 10x3" No.10's & 10 Plugs)



(E)

SHELF FIXING PACK
Quantity: 1 Pack
(includes: 10x1" No 8's & 10x2" No 8's)

If you have any missing components please take note of the part name and contact your supplier.

Wall Mounted Shelving is safe when used responsibly. If in doubt, contact the supplier.

Before commencing ensure you have the tools required, a spirit level, screwdriver and power drill. Ensure the wall type is appropriate and strong enough to mount the shelving and that fitting won't interfere with any pipework or electrical wires.

1

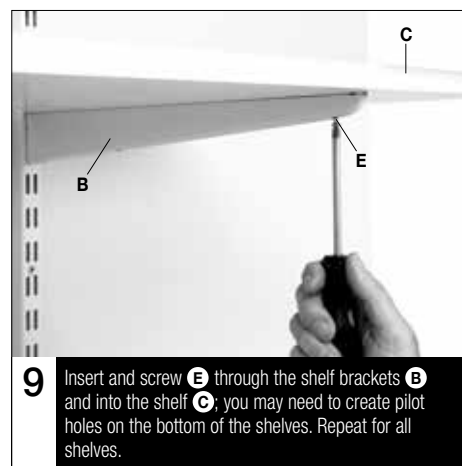
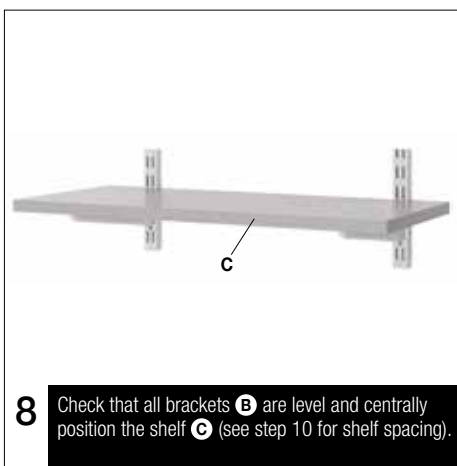
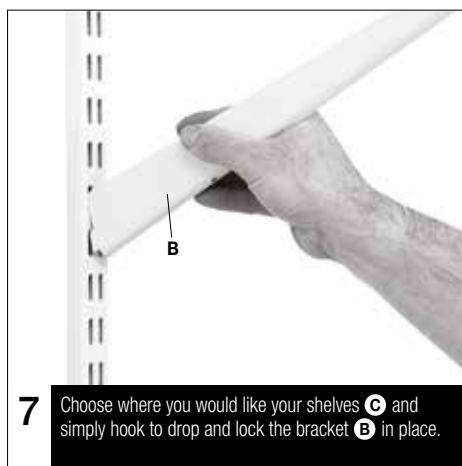
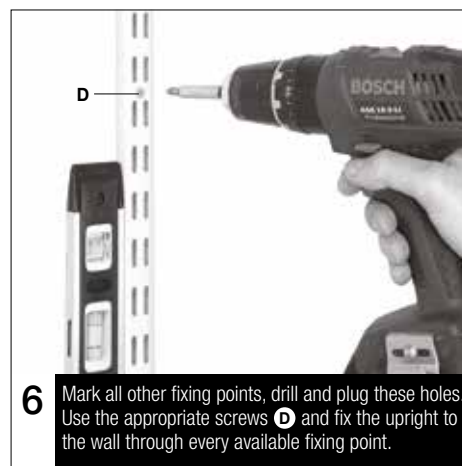
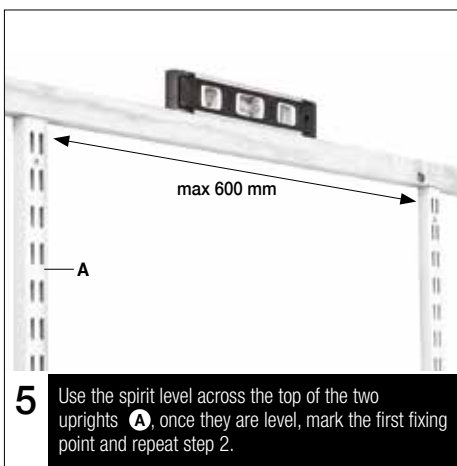
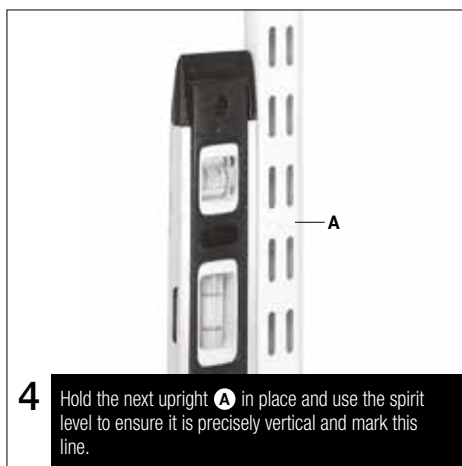
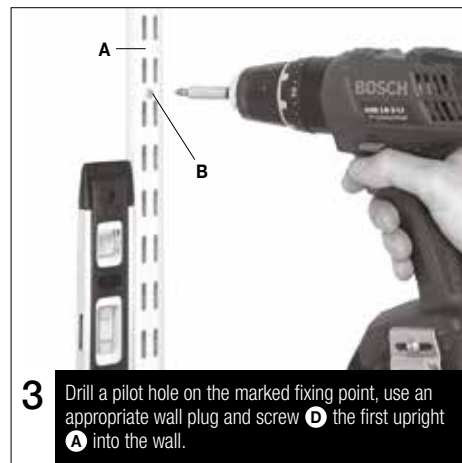

Space each shelf according to requirements.

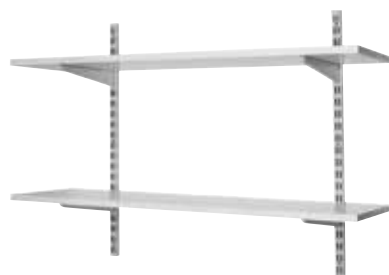

Maximum bracket load 50kg (all sizes)

10 SAFETY FEATURE: Drop-and-lock bracket design prevents the bracket from accidentally being dislodged during use.

Safety Instructions



Information:

If in doubt, contact the supplier:

- Read this guide before commencing assembly and retain for future reference
- Before commencing assembly, unpack carefully and check that all components ordered are included
- Assembly should be undertaken by a minimum of two competent people
- Tools – Spirit level, screwdriver and a power drill is required



Caution:

During assembly, ensure to:

- Take care during assembly and in use, particularly when lifting or stretching and when using tools
- Wear appropriate safety clothing – protective gloves and footwear are recommended
- Dispose of packaging materials responsibly



Warning:

Rules for the safe use of shelving:

- Ensure these instructions are retained for reference and that users are aware of the rules for safe use
- Never climb on the structure or stand on the shelving/workstation/workbench
- Do not lean or support ladders, steps, or other objects against shelving/workstation/workbench
- Always use safety steps to reach high shelves
- Do not use in damp or wet conditions
- Load heavy items on the lower shelves and lighter items on the higher shelves
- Ensure that the maximum load carrying capacities are not exceeded
- This product is designed for hand loading
- Please refer to the loading information supplied for details