

# Assembly Sheet

# BiGDUG ESSENTIALS ESD ANTI-STATIC DRAUGHTSMAN CHAIR

EL012

BLACK

520-720mm H x 455mm W x 455mm D



## COMPONENTS CHECK LIST:



(A)

**CASTORS/FEET**  
Quantity: 5



(B)

**FIVE BAR STAR BASE**  
Quantity: 1



(C)

**GAS LIFT**  
Quantity: 1



(D)

**FOOTREST**  
Quantity:  
Available separately



(E)

**BACKREST**  
Quantity: 1



(F)

**SEAT**  
Quantity: 1

**During assembly do not tighten bolts until all components are aligned properly, then tighten fully.**

If you have any missing components please take note of the part name and contact your supplier.

Seats are safe when used responsibly. If in doubt, contact the supplier.

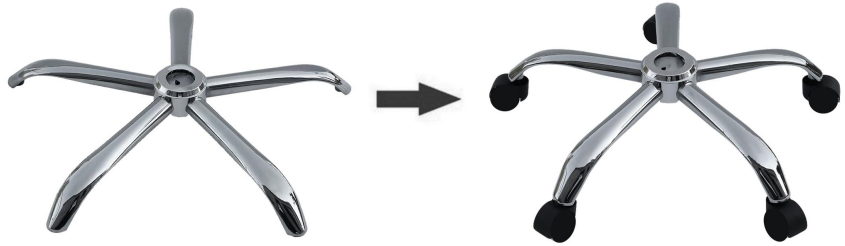

**1** Press five castors **A** or feet into the five star base **B**.

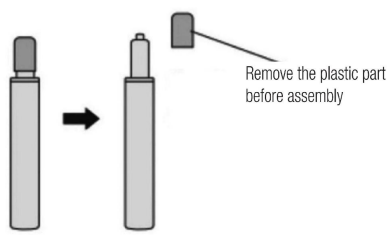

Remove the plastic part before assembly

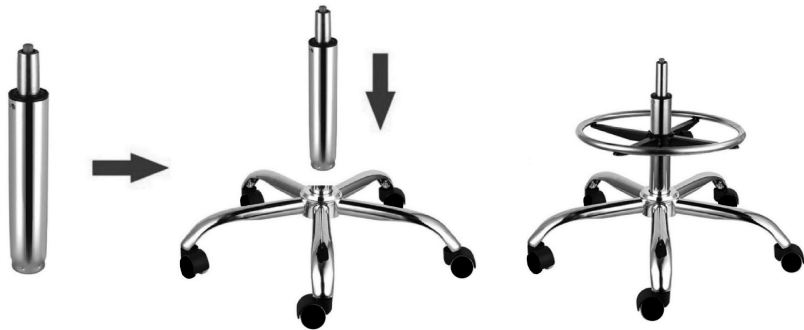

**2** Remove the plastic cap. Put the gas lift **C** into the hole of the base **B**. Install the footrest **D** (footrest available to purchase separately).



**3** Install the seat **F** on the gas lift **C**. Then install the backrest **E** and tighten it.

## Safety Instructions



### Information

**If in doubt, contact the supplier:**

- Read this guide before commencing assembly and retain for future reference
- Before commencing assembly, unpack carefully and check that all components ordered are included
- Assembly should be undertaken by a minimum of two competent people
- Tools – allen key (included)



### Caution

**During assembly, ensure to:**

- Take care during assembly and in use, particularly when lifting or stretching and when using tools
- Wear appropriate safety clothing – protective gloves and footwear are recommended
- Build on a suitable level floor, which is strong enough to support the load and allow adequate working space
- Dispose of packaging materials responsibly



### Warning

**Rules for the safe use of chairs:**

- Ensure these instructions are retained for reference and that users are aware of the rules for safe use
- Never climb on the structure or stand on the chair
- Do not lean or support ladders, steps, or other objects against chair
- Do not use in damp or wet conditions
- Ensure that the maximum load capacities are not exceeded
- Please refer to the loading information supplied