

**EN**

Original Instructions  
Version 1



34kW

# INFRARED DIESEL SPACE HEATER

01774



# 1. Preface

---

These are the original product instructions. This document is part of the product; retain it for the life of the product, passing it on to subsequent holders. Read this manual in full before attempting to assemble, operate, or maintain this product.

This Draper Tools manual describes the purpose of the product and contains all the necessary information to ensure its correct and safe use. Following all the instructions and guidance in this manual will ensure the safety of both the product and the operator and increase the lifespan of the product.

All photographs and drawings within this manual are supplied by Draper Tools to help illustrate correct operation of the product.

Every effort has been made to ensure the information contained in this manual is accurate. However, Draper Tools reserves the right to amend this document without prior warning. Always use the latest version of the product manual.

## 1.1 Product Reference

**User Manual for:** Jet Force Infrared Diesel Space Heater, 124,000 BTU/34 kW

**Stock No:** 01774

**Part No:** DSH-IR30-B

## 1.2 Revisions

**Version 1:** July 2022  
First release

As our manuals are continually updated, always ensure that the latest version is used.

For the latest version of this manual and the associated parts list, if applicable, please visit

[drapertools.com/manuals](http://drapertools.com/manuals)

## 1.3 Understanding the Safety Content of This Manual

**WARNING!** – Situations or actions that may result in personal injury or death.

**CAUTION!** – Situations or actions that may result in damage to the product or surroundings.

**Important:** – Information or instructions of particular importance.

## 1.4 Copyright © Notice

Copyright © Draper Tools Limited.

Permission is granted to reproduce this manual for personal and educational use **ONLY**. Commercial copying, redistribution, hiring, or lending is strictly prohibited.

No part of this manual may be stored in a retrieval system or transmitted in any other form or means without written permission from Draper Tools Limited.

In all cases, this copyright notice must remain intact.

|   |    |
|---|----|
| 1. Preface  | 2  |
| 1.1 Product Reference   | 2  |
| 1.2 Revisions   | 2  |
| 1.3 Understanding the Safety Content of This Manual                       | 2  |
| 1.4 Copyright © Notice  | 2  |
| 2. Contents   | 3  |
| 3. Warranty   | 4  |
| 4. Product Introduction   | 5  |
| 4.1 Scope   | 5  |
| 4.2 Specification   | 5  |
| 5. Health and Safety Information  | 6  |
| 5.1 General Health and Safety Precautions for This Heater                 | 6  |
| 5.2 Health and Safety Information for the Use of Diesel and Kerosene Fuel | 7  |
| 5.3 Connection to the Power Supply  | 8  |
| 6. Identification and Unpacking   | 9  |
| 6.1 Product Overview  | 10 |
| 6.2 What's in the Box?  | 10 |
| 6.3 Packaging   | 10 |
| 7. Preparing the Heater   | 11 |
| 7.1 Assembly  | 11 |
| 7.2 Acceptable Fuels  | 12 |
| 7.3 Fuelling the Heater   | 12 |
| 7.4 Positioning the Heater  | 12 |
| 8. Operating Instructions   | 14 |
| 8.1 Switching On the Heater   | 14 |
| 8.2 Switching Off the Heater  | 14 |
| 8.3 Automatic Power Cut-Outs  | 14 |
| 9. Maintenance and Troubleshooting  | 15 |
| 9.1 General Maintenance and Storage                                       | 15 |
| 9.2 Draining the Fuel   | 15 |
| 9.3 Fuel Tank Care  | 15 |
| 9.4 Filter Care   | 15 |
| 9.5 Nozzle Care   | 15 |
| 9.6 Spark Plug Care   | 15 |
| 9.7 Photocell Care  | 15 |
| 9.8 Storing the Heater  | 15 |
| 9.9 Troubleshooting   | 16 |
| 9.10 Control PCB Circuit Diagram  | 17 |
| 10. Spares, Returns and Disposal  | 18 |
| 11. Explanation of Symbols  | 19 |

### 3. Warranty

---

Draper Tools products are carefully tested and inspected before shipment and are guaranteed to be free from defective materials and workmanship.

Should the tool develop a fault, return the complete tool to your nearest distributor or contact Draper Tools directly. Contact information can be found at the back of this manual.

Proof of purchase must be provided.

If, upon inspection, it is found that the fault occurring is due to defective materials or workmanship, repairs will be carried out free of charge. This warranty period covers parts and labour for 12 months from the date of purchase. Where tools have been hired out, the warranty period covers 90 days from the date of purchase.

This warranty does not apply to any consumable parts, batteries or normal wear and tear, nor does it cover any damage caused by misuse, careless or unsafe handling, alterations, accidents, or repairs attempted or made by any personnel other than the authorised Draper Tools repair agent.

In all cases, to make a claim for faulty workmanship or materials within the standard warranty period, please contact or return the product to the place of purchase. Proof of purchase may be required.

If the place of purchase is no longer trading or if you experience any difficulties with your warranty, please contact Customer Services with the product details and your proof of purchase. Contact details can be found at the back of this manual.

If the tool is not covered by the terms of this warranty, repairs and carriage charges will be quoted and charged accordingly.

This warranty supersedes any other guarantees expressed or implied and variations of its terms are not authorised.

Your Draper Tools guarantee is not effective until you can produce, upon request, a dated receipt or invoice to verify your purchase within the guarantee period.

Please note that this warranty is an additional benefit and does not affect your statutory rights.

**Draper Tools Limited**

4.1 Scope

This heater is designed to heat open and semi-open spaces through the combustion of diesel and kerosene fuels and has electronic controls.

**WARNING! This product is not a toy and must be respected.**

Read this manual in full before attempting to assemble, operate or maintain the product, and retain it for later use.

4.2 Specification

|                    |                           |
|--------------------|---------------------------|
| Stock No.          | 01774                     |
| Part No.           | DSH-IR30-B                |
| Motor:             |                           |
| Rated voltage      | 230V AC                   |
| Rated frequency    | 50Hz                      |
| Rated input        | 59W                       |
| Heat output        | 34kW/124,000 BTU          |
| Fuel               | Diesel/Kerosene           |
| Diesel consumption | 2.6L/h                    |
| Fuel tank capacity | 40L                       |
| Net weight         | 34.73kg                   |
| Dimensions         | W 695 x H 955 x D 1,205mm |

## 5. Health and Safety Information

---

**Important:** Read all the Health and Safety instructions before attempting to operate, maintain or repair this product. Non-compliance with these instructions may result in injury or damage to the user or the product.

**WARNING! Improper use of this heater may result in serious injury or death from burns, fire, explosions, electrical shock and carbon monoxide poisoning.**

### 5.1 General Health and Safety Precautions for This Heater

- Observe all standard safety precautions and good practices when working with electrical equipment.
- Take extra care when using this product around children.
  - Children of less than three years should be kept away unless continuously supervised.
  - Children aged between three years and eight years shall only switch on/off the appliance if it has been placed or installed in its intended normal operating position and they have been given supervision or instruction concerning use of the appliance in a safe way and understand the hazards involved.
  - Children aged between three years and eight years shall not plug in, regulate and clean the appliance or perform user maintenance.
- Keep your work environment clear and well-lit, with bystanders at a safe distance.
- Before every use, inspect the heater for broken, cracked, loose or corroded parts.

**Important:** **DO NOT** use this product if it is damaged in any way. Contact Draper Tools to discuss repair and replacement options.
- Use the product only in the manner instructed in this manual and **DO NOT** modify it in any way.
- This heater is for indoor use **ONLY**.
- **DO NOT** expose this product to temperatures greater than 60°C.
- **DO NOT** use this heater in small rooms that are occupied by individuals that are not capable of leaving the room on their own, unless constant supervision is provided.
- **DO NOT** use the heater in dusty environments.
- Position the heater on a firm and level surface during use and ensure that the adjustable screws are tightly secured.
- The heater must **ONLY** be used in its normal operating position.
- **ALWAYS** observe the correct clearances between the heater and surrounding objects:
  - **Outlet:** 2.5m (8ft)
  - **Sides, top and rear:** 1.25m (4ft)
- **DO NOT** position the heater in close proximity to curtains or other combustible materials that may move and come into contact with the heater.
- **DO NOT** position this heater in the vicinity of combustible materials, in explosive environments or in the presence of flammable or combustible gases and vapours.
- **DO NOT** position this heater below or pointing towards a power socket or outlet.
- **DO NOT** use the heater if the wheel assembly has been removed.
- Ensure that the power switch is in the "off" (O) position before connecting the heater to the power supply.
- **ONLY** use this product with power supplies that match the rated voltage of the heater.
  - **NEVER** use this heater with an extension lead, multi-socket or plug adaptor; it must be plugged directly into the power supply.
  - **NEVER** plug more than one heater into the same power outlet.
- **NEVER** abuse the power cord.
  - Untangle the power cord fully before connecting it to the power supply.
  - **NEVER** remove the plug from the power supply by pulling on the cord.
  - **DO NOT** pull the product using the cable or plug.
  - Keep the power cord away from sources of heat, liquids, sharp edges and moving parts.
  - The power cord attached to this product is not suitable for use on building sites.
- **NEVER** allow the power cord to come into contact with other heated objects or direct the heater at the power cord or supply.
- This is a Class I appliance.
  - This product requires an earth connection to protect against electric shock from accessible conductive parts in the event of a failure of the basic insulation.
  - To reduce the risk of electric shock, avoid contact with earthed objects during use.

- **ALWAYS** check that the heater is positioned safely before turning it on.
- **NEVER** leave the heater unattended while it is on under any circumstances.
- Avoid body contact with earthed or grounded surfaces, such as pipes, radiators, ranges and refrigerators.
- **DO NOT** use this heater with a programmer, timer, separate remote-control system or any other device that switches the heater on automatically as it may be covered or positioned incorrectly when activated and pose a fire risk.
- **NEVER** cover any part of the heater as this may cause it to overheat or the covering item to ignite or burn.
- **NEVER** insert foreign objects through the heat plate or other openings in the heater body.
- **WARNING! Risk of shock!**
  - **DO NOT** allow the heater to come into contact with water or any other liquid.
  - **DO NOT** use this heater in the vicinity of a bath, shower, swimming pool or other body of water.
  - **DO NOT** touch the heater with wet hands.
- **WARNING! Some parts of the product become extremely hot during use and may cause burns.**
  - **DO NOT** touch any metal part of the heater other than the handle or wheels during or immediately after use.
  - **DO NOT** touch or otherwise interfere with the fuel tank while the heater is in use or is still hot.
  - **ALWAYS** switch off the heater, disconnect it from the power supply and allow it to cool for at least 20 minutes before attempting to move or reposition it.
  - Particular attention **MUST** be given when children and vulnerable people are present.
- **ALWAYS** switch off and disconnect the heater and allow at least 20 minutes for it to cool before considering refuelling.
- **ALWAYS** wear suitable protective gloves and other clothing during refuelling.
- **NEVER** transport the heater with fuel in the fuel tank; drain and store or dispose of **all** fuel responsibly before transporting the heater.
- **NEVER** start the engine if you can smell petrol vapour in the air.
  - If petrol vapour is present, wait for it to dissipate or move to a new location.
- The engine and fuel get hot during use.
  - **DO NOT** touch the engine during or immediately after use and allow it to cool before refuelling.
- **NEVER** remove the fuel cap while the engine is running or immediately after use.
  - Take care when opening the fuel cap after use as hot vapour may be released from the opening.
- **NEVER** place objects on the engine while it is in use and keep all air vents clear of dust, dirt and other obstructions.
- Store all fuels in a cool, clean and dry environment, away from direct sunlight and out of reach of children.
  - Adhere to **all** local guidance relating to the correct storage of fuel.

**WARNING! Diesel is a carcinogenic substance, and kerosene is known to have health implications if handled improperly. Exercise extreme caution when transporting and storing fuel and during refuelling. Clean up spillages IMMEDIATELY and dispose of fuel responsibly and in accordance with local regulations.**

**WARNING! Burning diesel emits toxic carbon monoxide: a colourless and odourless gas. Breathing exhaust fumes can cause loss of consciousness, permanent respiratory damage and eventually death. ONLY operate this machine in a well-ventilated environment. NEVER use this heater in living or sleeping areas.**

Exposure to concentrated carbon monoxide gas can result in carbon monoxide poisoning. If you exhibit symptoms including headaches, dizziness or nausea after being around the heater, it may not be working properly. Switch off and disconnect the heater and move to a well-ventilated area **IMMEDIATELY**. Have the heater checked for correct operation by a qualified engineer before next use.

## 5.2 Health and Safety Information for the Use of Diesel and Kerosene Fuel

- This product is suitable for use with diesel and kerosene fuel **ONLY**.  
**WARNING! DO NOT use fuels such as petrol, benzene, paint thinners or other oil compounds in this heater under any circumstances.**
- **NEVER** smoke in the vicinity of the machine, especially during refuelling.
- **NEVER** refuel the heater while it is switched on or is still hot.

### 5.3 Connection to the Power Supply

This appliance is supplied with an approved plug and cable for your safety.

If the power supply cord is damaged, it must be replaced by Draper Tools, an authorised service agent or similarly qualified personnel in order to avoid a hazard.

The damaged or incomplete plug, when cut from the cable, shall be disabled to prevent connection to a live electrical outlet.

This product is Class I† and is designed for connection to a power supply matching that detailed on the rating label and compatible with the plug fitted.

**CAUTION! DO NOT use this product with an extension lead or multi-socket.**

The value of the fuse fitted is marked on the pin face of the plug. Should the fuse need replacing, ensure the substitute is of the correct rating, approved to BS 1363/A and ASTA or BS Kite marked. This should only be performed by suitably qualified personnel.

ASTA 

BSI 

†**Earthed:** This product requires an earth connection to protect against electric shock from accessible conductive parts in the event of a failure of the basic insulation.



6.1 Product Overview

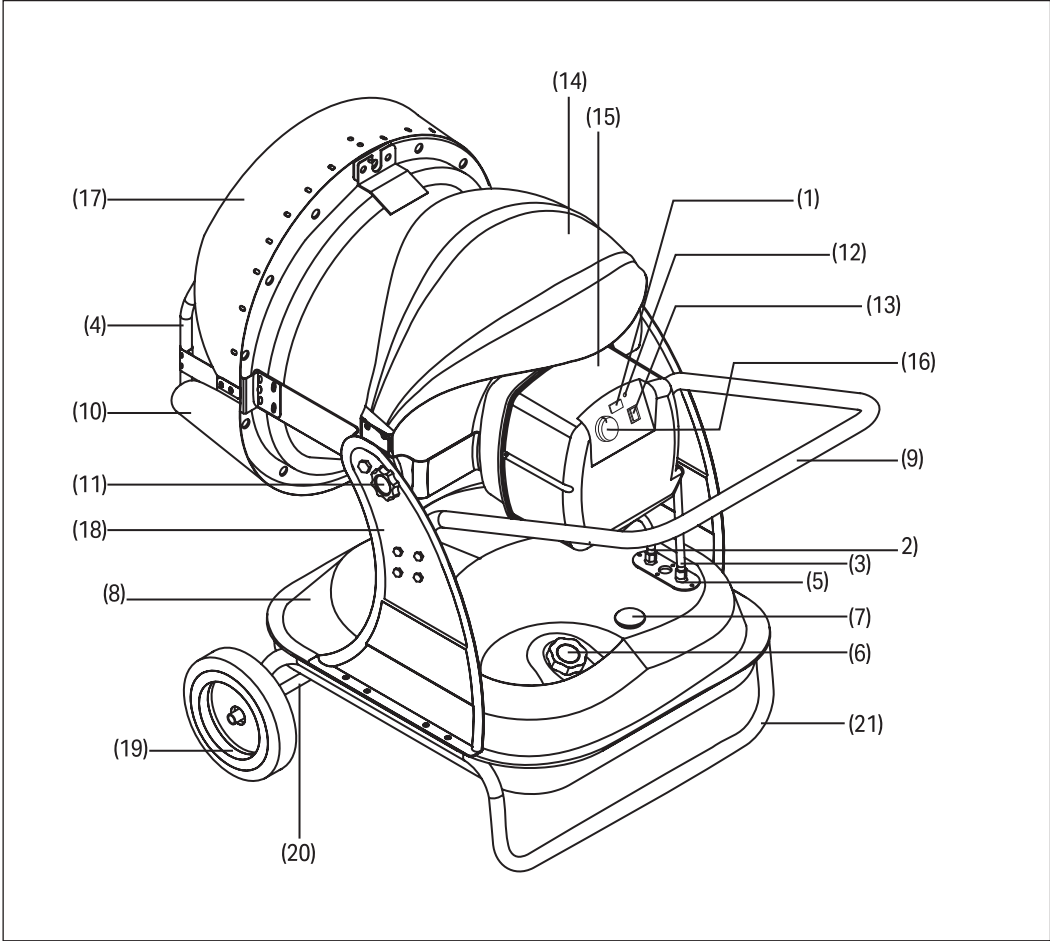

- |                                 |                               |
|---------------------------------|-------------------------------|
| (1) Digital display             | (12) Power indicator          |
| (2) Fuel pipe                   | (13) Power switch             |
| (3) Return pipe                 | (14) Protective umbrella      |
| (4) Front guard                 | (15) Rear cover               |
| (5) Filter access plate         | (16) Temperature control dial |
| (6) Fuel cap                    | (17) Upper reflector          |
| (7) Fuel gauge                  | (18) Vertical supports        |
| (8) Fuel tank                   | (19) Wheel                    |
| (9) Handle                      | (20) Wheel axle               |
| (10) Lower reflector            | (21) Wheel support frame      |
| (11) Position adjustment screws |                               |

6.2 What's in the Box?

Carefully remove the product from the packaging and examine it for any signs of damage that may have occurred during shipment.

Before assembling the product, lay the contents out and check them against the parts listed below. If any part is damaged or missing, do not attempt to use the product. Please contact the Draper HelpLine; contact details can be found at the back of this manual.

- |     |                         |     |                             |
|-----|-------------------------|-----|-----------------------------|
| (A) | 1 x Upper reflector     | (I) | 4 x M6 x 40mm flange bolts  |
| (B) | 1 x Lower reflector     | (J) | 4 x M5 x 35mm flange bolts  |
| (C) | 1 x Umbrella            | (K) | 16 x M5 x 10mm flange bolts |
| (D) | 1 x Guard               | (L) | 2 x 17mm washers            |
| (E) | 1 x Handle              | (M) | 2 x Pipe washers            |
| (F) | 1 x Wheel support frame | (N) | 4 x M6 flange nuts          |
| (G) | 1 x Axle                | (O) | 4 x M5 flange nuts          |
| (H) | 2 x Wheels              | (P) | 2 x Split pins              |

6.3 Packaging

Keep the product packaging for the duration of the warranty period for reference should the product need to be returned for repair.

**WARNING! Keep packaging materials out of reach of children. Dispose of packaging correctly and responsibly and in accordance with local regulations.**

Please visit [drapertools.com](http://drapertools.com) for our full range of accessories and consumables.

## 7. Preparing the Heater

EN

### 7.1 Assembly

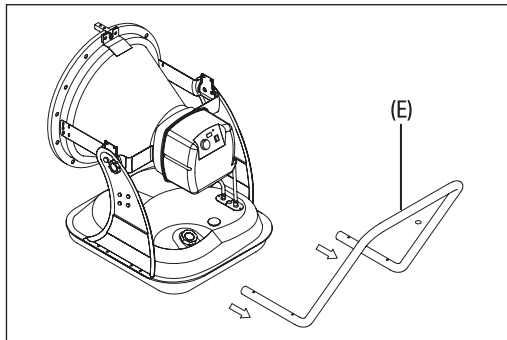

Fig. 1

1. Remove the handle (E) from its shipment position and align it with the open holes on the vertical supports (18) so that it is angled slightly upwards.

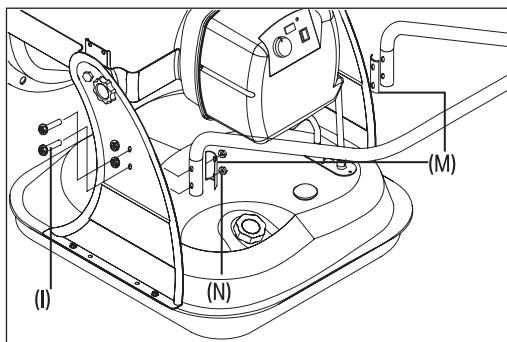

Fig. 2

2. Place a pipe washer (M) around each end of the handle and secure the handle firmly in place using four M6 x 40mm flange bolts (I) and M6 flange nuts (N).

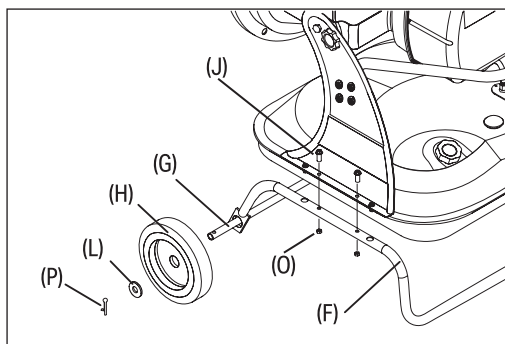

Fig. 3

3. Pass the wheel axle (G) through the holes at the ends of the wheel support frame (F).
4. Slide a wheel (H) and 17mm washer (L) onto each end of the axle and secure them in place using the two split pins (P).
5. Use four M5 x 35mm flange bolts (J) and M5 flange nuts (O) to fix the wheel frame to the base of the vertical supports.

**Important:** The wheels should be positioned at the front of the heater when attached.

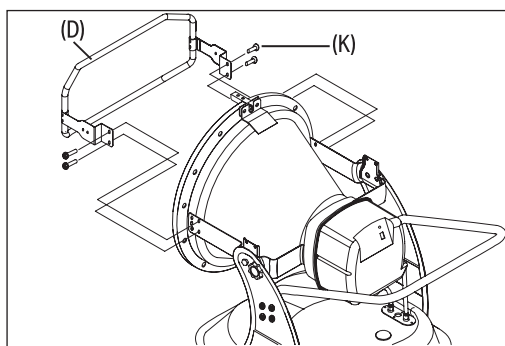

Fig. 4

6. Use four M5 x 10mm flange bolts (K) to attach the guard (D) to the cone body.

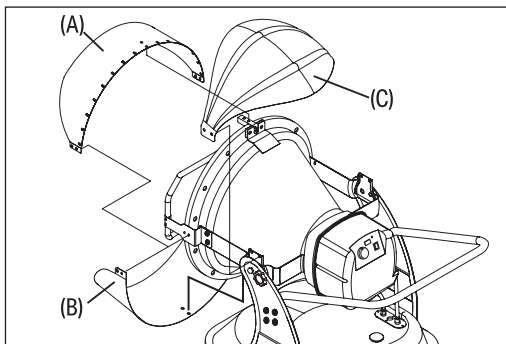

Fig. 5

- Use four M5 x 10mm flange bolts to attach the reflectors (A) (B) to the guard bracket.

**Important:** The upper reflector (A) should be placed against the outside edge of the guard bracket, with the lower reflector (B) placed against the outside edge of the lower reflector.

- Insert two M5 x 10mm flange bolts through the bottom of the lower reflector to secure it in place.
- Insert two M5 x 10mm flange bolts through the top of the upper reflector to secure it in place.
- Use four M5 x 10mm flange bolts to attach the protective umbrella (C) to the openings above the vertical supports.

### 7.2 Acceptable Fuels

**WARNING!** This heater is suitable for use **ONLY** with standard diesel or kerosene. **NEVER** use petrol, oil, used oils, naphtha, paint thinners, alcohol or other highly flammable fuels. Use of an incorrect fuel may cause an explosion and serious injury.

Always ensure that the fuel tank is clean both before fuelling and once filled. Foreign matter such as rust, dirt or water may cause the ignition control to shut down the heater and may require regular cleaning of the fuel system.

Always follow local guidance relating to the storage of diesel and kerosene.

**WARNING!** **NEVER** store diesel or kerosene in a living space. Store it in a well-ventilated area well away from any residential spaces and away from direct sunlight and sources of ignition and heat.

**CAUTION!** Kerosene deteriorates over time. Do not use old kerosene in this heater.

### 7.3 Fuelling the Heater

**WARNING!** **ALWAYS** ensure that the heater is switched off, disconnected from mains power and has completely cooled before adding fuel. **NEVER** add fuel to the heater while it is running.

**Important:** **ALWAYS** wear protective gloves during refuelling.

To add fuel to the heater, remove the fuel cap (6) and pour the fuel directly into the fuel tank until the fuel gauge (7) reads F, observing the following conditions:

- ALWAYS** place the heater on a level surface when fuelling.
- NEVER** overfill the heater and wipe up any spillages **IMMEDIATELY**.
- NEVER** add fuel to the heater while indoors; fuel the heater **ONLY** in well-ventilated areas.

### 7.4 Positioning the Heater

**WARNING!** This heater is designed for use **ONLY** in well-ventilated areas. Combustion of the fuels used in this heater produces toxic fumes that are dangerous if inhaled. **NEVER** use this heater to heat residential spaces.

Provide a fresh air opening of at least 0.28m<sup>2</sup> (3ft<sup>2</sup>) for every 30,000kCal/h (189,000 BTU). This heater requires 0.292m<sup>2</sup> (3.15ft<sup>2</sup>), which can be approximated as:

- A two-car garage door raised 15.25cm (6").
- A single-car garage door raised 22.9cm (9").
- Two 76.2cm (30") windows raised 38.1cm (15").

Position the heater so that it stands upright unaided on a firm, level and fire-resistant surface and is located a safe distance away from flammable objects and wet environments.

Set the angle of the heater by loosening the position adjustment screws (11), tilting the heater as required and then tightening the screws to secure it.

**Important:** **ALWAYS** ensure that the position adjustment screws are tightly secured before switching on the heater.

Ensure that the temperature control dial (16) is set to the

lowest position and the power switch (13) is in the OFF position, then connect the plug directly to a power outlet.

**WARNING! DO NOT attempt to adjust the angle of the heater during or immediately after use. ALWAYS switch off the heater, disconnect the power supply and allow it to cool before loosening the position adjustment screws.**

**Important:** Before use, read and understand all the safety instructions listed in this manual.

8.1 Switching On the Heater

**WARNING!** This heater emits infrared radiation. **ALWAYS** ensure that there are no combustible materials in the vicinity of the heater.

**Important:** If the heater has recently been switched off, allow at least ten seconds before switching it back on again.

- 1. Ensure that the fuel tank has been sufficiently filled and the fuel cap has been securely and correctly fitted.
- 2. Ensure that the power switch is in the **OFF** position and the temperature control dial is set to the lowest position.
- 3. Connect the heater to a mains power supply.  
**Important:** Where an extension cable must be used, it **MUST** meet the following requirements:

| Cable length       | Min. cable gauge |
|--------------------|------------------|
| 1.8–3m (6–10")     | 1.0mm            |
| 3.5–30.5m (11–11") | 1.3mm            |
| 31–60m (101–200")  | 1.6mm            |

8.3 Automatic Power Cut-Outs

This heater is equipped with four safety features that will automatically switch off the device under specific circumstances:

| Feature                  | Shutdown conditions   |
|--------------------------|---|
| Thermal cut-out          | The internal temperature of the heater has reached an unsafe level. Switch off the heater, disconnect it from mains power and allow it to cool for at least 20 minutes before attempting to restart it.     |
| Short-circuit protection | The circuitry has short-circuited or overloaded and the internal fuse has blown. Have the device checked by a qualified and authorised engineer before reuse.   |
| Flame-out sensor         | An internal photocell monitors the condition of the flame in the combustion chamber during normal operation. If the flame is extinguished while the heater is switched on, it will automatically shut down. |
| Tilt switch              | The heater automatically shuts down if the unit is tilted by an angle of <b>20° or greater</b> in order to protect the ground from heat damage.   |

If the power cut-outs activate frequently, the heater may need to be serviced. Contact Draper Tools for support.

- 4. Move the power switch (13) to the **ON** position.
- 5. Turn the temperature control dial (16) to the desired setting; the current temperature is shown on the digital display (1).  
**Important:** If the target temperature is less than the current ambient temperature, the heater will not start.

8.2 Switching Off the Heater

When switching off the heater:

- 1. Turn the temperature control dial (16) to the lowest setting, then move the power switch (13) to the **OFF** position.
- 2. Wait a few minutes for the cooling fan to stop rotating.
- 3. Disconnect the heater from mains power.  
**CAUTION! DO NOT unplug the heater until the cooling fan has completely stopped or the combustion chamber may be damaged. After switching off, wait at least ten seconds before restarting the heater.**

**Important:** Read all the Health and Safety information in this manual before attempting to maintain this product. All maintenance should be carried out **ONLY** by authorised and suitably qualified personnel.

**WARNING! ALWAYS ensure that the heater is switched off, disconnected from the power supply and has fully cooled before attempting any maintenance on this product.**

## 9.1 General Maintenance and Storage

- Keep the heater clean and dry.
- Clean the heater body and reflectors using a dry cloth **ONLY**.
- Any maintenance to the plug and power cable **MUST** be performed by Draper Tools or its authorised agent.
- The heater should be inspected at least once a year by suitably qualified personnel.
  - Any repairs to the heater must be carried out by suitably qualified personnel.
- Store the heater in a clean and dry location, out of reach of children.

## 9.2 Draining the Fuel

**Important:** Read all the Health and Safety guidance for the use of petrol as a fuel before filling or draining this product.

To drain the fuel from the product, remove the fuel cap and use a siphon to extract the fuel into a suitable container, ensuring that there is no fuel left in the tank.

If dirt or debris is present in the drained fuel or tank, pour a couple of litres of clean fuel into the tank and manoeuvre it around to clean the tank interior. Then drain the fuel again to prevent the filters from clogging.

**CAUTION! DO NOT use water to clean the inside of the fuel tank.**

**Important:** Wipe up any spillages **IMMEDIATELY** and dispose of old fuel responsibly and in accordance with local regulations.

## 9.3 Fuel Tank Care

The fuel tank (8) interior should be cleaned after every 200 hours of use or as necessary. To clean the fuel tank, add a couple of litres of diesel or kerosene and manoeuvre it around the interior of the tank, ensuring that the whole surface is coated, then drain the fuel tank (see 9.2 Draining the Fuel).

## 9.4 Filter Care

The filter should be cleaned at least twice a year or as necessary. Rinse the filter in diesel or kerosene and allow it to completely dry before reinstalling it in the heater. The filter can be accessed by removing the filter access plate (5), unscrewing the filter capsule from the nut and removing the filter from within it.

**Important:** The filter may drip when removed. Clean up any spillages immediately.

**Important:** In the event that incorrect or contaminated fuel is used in the heater, the filter must be cleaned thoroughly before next use.

## 9.5 Nozzle Care

The nozzle should be cleaned in kerosene or replaced at least once a year. In the event that incorrect or contaminated fuel is used in the heater, it must be replaced immediately.

Contact Draper Tools to discuss servicing options.

## 9.6 Spark Plug Care

The spark plug should be cleaned and its gap checked and adjusted after every 600 hours of use or as necessary. In the event that incorrect or contaminated fuel is used in the heater, it must be replaced immediately.

Contact Draper Tools to discuss servicing options.

## 9.7 Photocell Care

The photocell tube should be cleaned at least once a year or as necessary using cotton wetted in water or alcohol.

Contact Draper Tools to discuss servicing options.

## 9.8 Storing the Heater

**Important:** **ALWAYS** ensure that the heater is switched off, disconnected from the power supply and has cooled thoroughly before storing it.

- Drain the heater of all fuel before storing it; see 9.2 Draining the Fuel.
- Store the heater in a clean and dry location, out of reach of children.
- Keep the heater out of direct sunlight and away from combustible materials and sources of ignition when it is stored.

## 9.9 Troubleshooting

The heater is preprogrammed with a number of error codes that may be shown on the digital display (1).

| Error code | Error type                       | Possible cause  | Remedy   |
|------------|----------------------------------|---|--|
| E0         | Operator error                   | The power switch is moved to the <b>ON</b> position before the heater is connected to the power supply. | Disconnect the heater from the power supply, move the power switch to the <b>OFF</b> position, then reconnect the heater.                          |
| E1         | Photocell error                  | There is no fuel in the fuel tank.  | Switch off and disconnect the heater, then refill the fuel tank.   |
|            |                                  | The fuel is contaminated or dirty.  | Drain and refill the fuel tank; see <b>9.2</b> .   |
|            |                                  | The fuel filter is dirty or blocked.  | Clean or replace the filter; see <b>9.4</b> .  |
|            |                                  | The photocell is dirty or faulty.   | Have the photocell cleaned or replaced. Contact Draper Tools for support.  |
|            |                                  | The ignition has failed.  | Contact Draper Tools for support.  |
| E2         | Temperature control sensor error | The control sensor cable is damaged or disconnected.  | Contact Draper Tools for repair and replacement options.   |
|            |                                  | The temperature control sensor is damaged or faulty.  | Contact Draper Tools for repair and replacement options.   |
|            |                                  | The current ambient temperature is higher than 60°C.  | If this temperature assessment is correct, the heater is functioning normally. Otherwise, contact Draper Tools for repair and replacement options. |
| E3         | Thermostat error                 | The internal temperature of the heater is too high.   | Switch off the heater, disconnect it from the power supply and allow it to cool thoroughly before restarting it.                                   |
|            |                                  | The anti-tilt sensor has been activated   | Switch off the heater, disconnect it from the power supply and allow it to cool. Then place it on a firm and level surface before restarting.      |
| E4         | Blower motor error               | The blower motor cable is damaged or disconnected.  | Contact Draper Tools for repair and replacement options.   |
|            |                                  | The blower motor fan is obstructed.   | Remove the reflectors, umbrella and heat plate and check for any obstructions.   |
| Hi         | Temperature conditions           | The current ambient temperature is greater than 59°C.   | The ambient temperature is outside of the operating temperatures of this heater.   |
| Lo         |                                  | The current ambient temperature is less than -9°C.  | The ambient temperature is outside of the operating temperatures of this heater.   |
| CN         |                                  | Continuous operation.   | The heater is functioning normally.  |



9.10 Control PCB Circuit Diagram

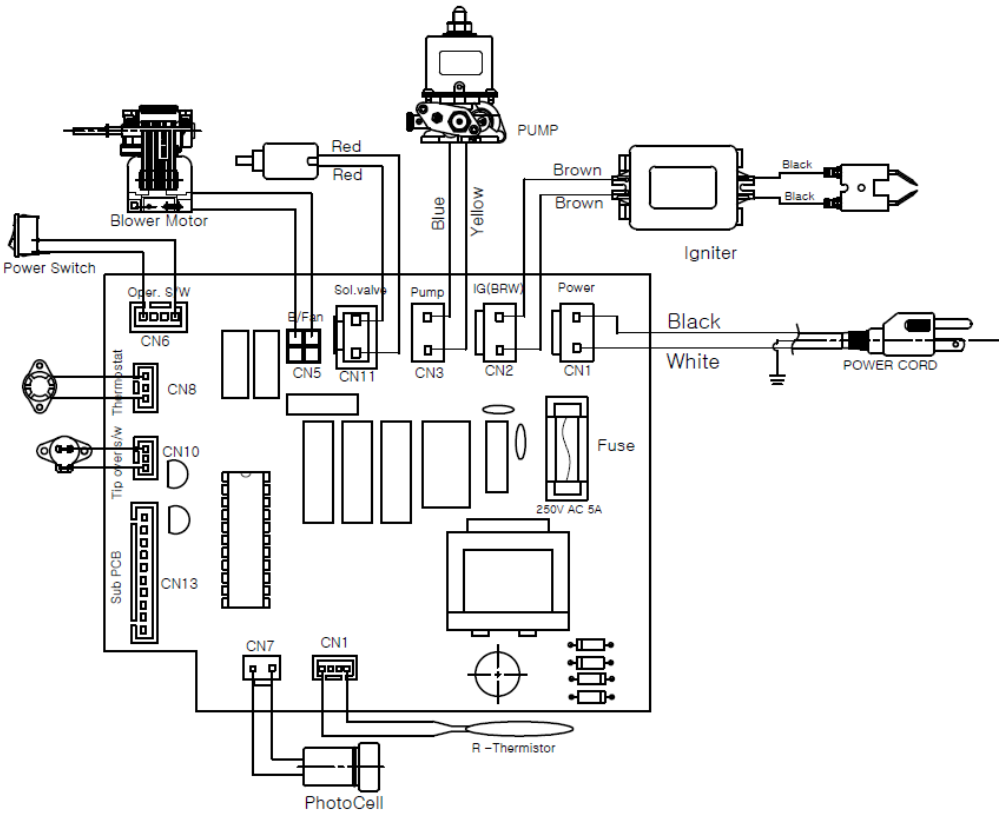

For spare parts, servicing, and repair and replacement options, please contact the Draper Tools Product Helpline for details of your nearest authorised agent.

Draper Tools will endeavour to hold any spare parts, if applicable, for seven years from the date that it sells the final matching stock item.















Any servicing or repairs carried out by unauthorised personnel or installation of spare parts not supplied by Draper Tools will invalidate your warranty.

**Important:** For safety, **ALWAYS** drain and clean the product of any oil, fuel, chemicals or other substances before returning it to Draper Tools or its authorised agent. Store these materials in suitable containers and dispose of them in accordance with local regulations. Draper Tools and its agents cannot be responsible for the disposal of these substances.

At the end of its working life, dispose of the product responsibly and in line with local regulations. Recycle where possible.

- **DO NOT** dispose of this product with domestic waste; most local authorities provide appropriate recycling facilities.
- **DO NOT** burn or incinerate the product after use.
- Dispose of diesel and kerosene separately and in accordance with local regulations; **DO NOT** abandon it in the environment.



|  |   |   |   |
|--|---|---|---|
|    | Read the instruction manual                   |  | Class I appliance   |
|    | Warning!                                      |  | WEEE –<br>Waste Electrical & Electronic Equipment<br>Do not dispose of this product with domestic waste |
|    | Danger of electric shock                      |  | UK Conformity Assessed  |
|    | Rated voltage                                 |  | European Conformity   |
|    | Rated input                                   |   |   |
|    | Do not cover                                  |   |   |
|    | Do not incinerate or throw onto fire          |   |   |
|   | Do not abandon in the environment             |   |   |
|  | Product weight                                |   |   |
|  | For indoor use only;<br>do not expose to rain |   |   |

## Contact Details

### **Draper Tools**

Draper Tools Limited  
Hursley Road  
Chandler's Ford  
Eastleigh  
Hampshire  
SO53 1YF  
UK

**Website:** [drapertools.com](http://drapertools.com)

**Email:** [sales@drapertools.com](mailto:sales@drapertools.com)

**Product Helpline:** +44 (0) 23 8049 4344

**Telephone Sales Desk:** +44 (0) 23 8049 4333

**General Enquiries:** +44 (0) 23 8026 6355

**General Fax:** +44 (0) 23 8026 0784

### **Delta International**

Delta International BV  
Oude Graaf 8  
6002 NL  
Weert  
Netherlands

Please contact the Draper Tools Product Helpline for repair and servicing enquiries.