

# Guide to Assembly & Usage

## BiGDUG | Garage Drawer Cabinet Workbench | GLWB123

COMPONENT CHECK LIST	
Component	Quantity
<b>A</b> Worktop	1
<b>B</b> Left Panel	1
<b>C</b> Right panel	1
<b>D</b> Centre panel	1
<b>E</b> Base panel	1
<b>F</b> Rear panel	2
<b>G</b> Cross beam	1
<b>H</b> Small drawer base	6
<b>I</b> Small drawer back panel	6
<b>J</b> Small drawer front panel	6
<b>K</b> Large drawer base	1
<b>L</b> Large drawer back panel	1
<b>M</b> Large drawer front panel	1
<b>N</b> Left hand drawer runner	7
<b>O</b> Right hand drawer runner	7
<b>P</b> Adjustable feet	4
<b>Q</b> ST4.2×9 Screw	12
<b>R</b> M6×12 Bolt	14
<b>S</b> M6×10 Bolt	56
<b>T</b> M6 Spring washer	58
<b>U</b> M6 Nut	58

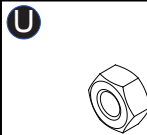
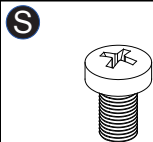
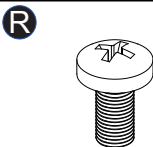
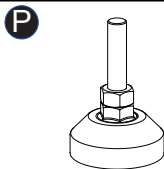
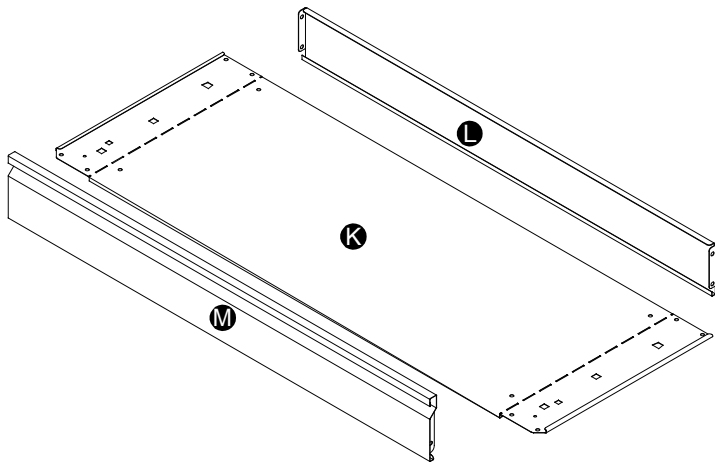
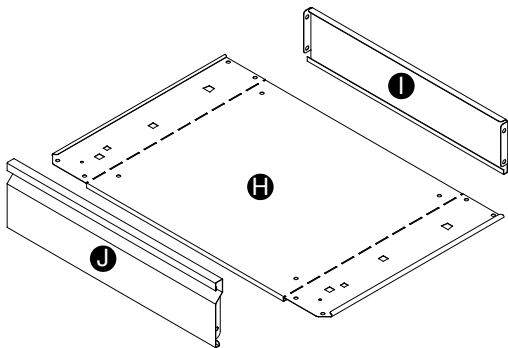
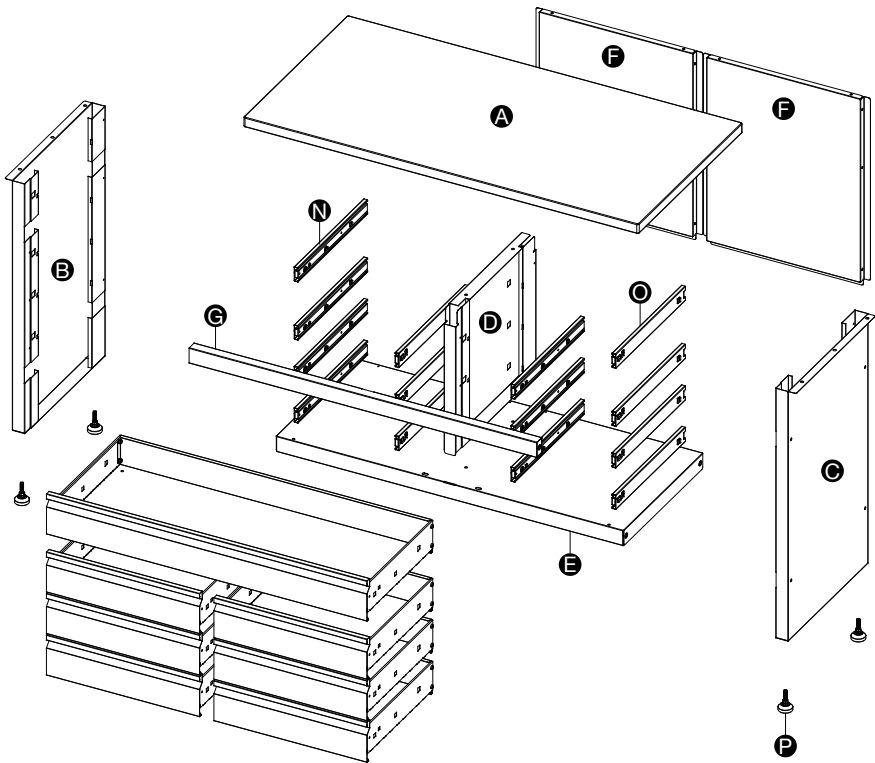

# Assembly BIGDUG® Garage Drawer Cabinet Workbench | GLWB123

1 Fold drawer base **H + K** .

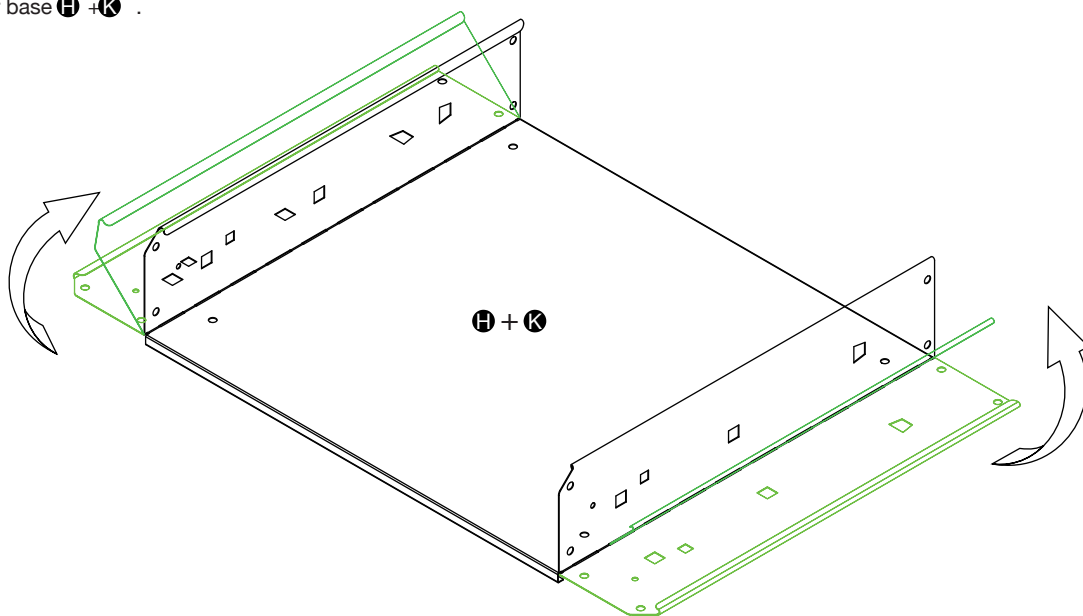

2 Attach drawer back panels **I + L** and front panels **J + M** to the folded drawer bases use fixings **S + T + U** .

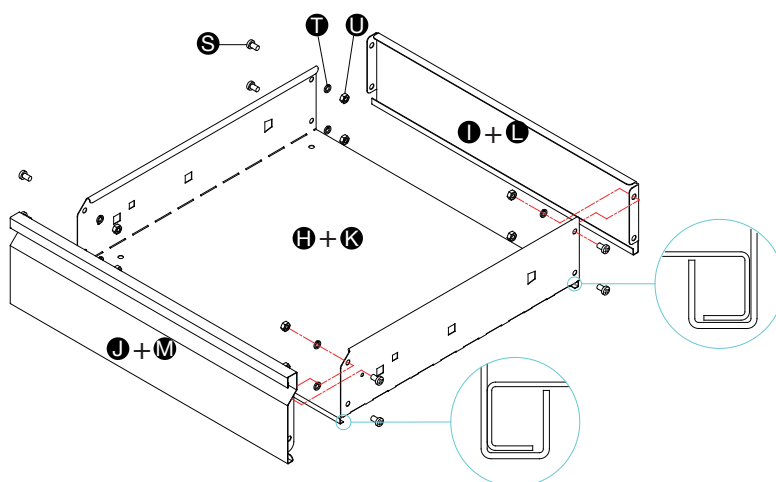

3 Completed drawer .

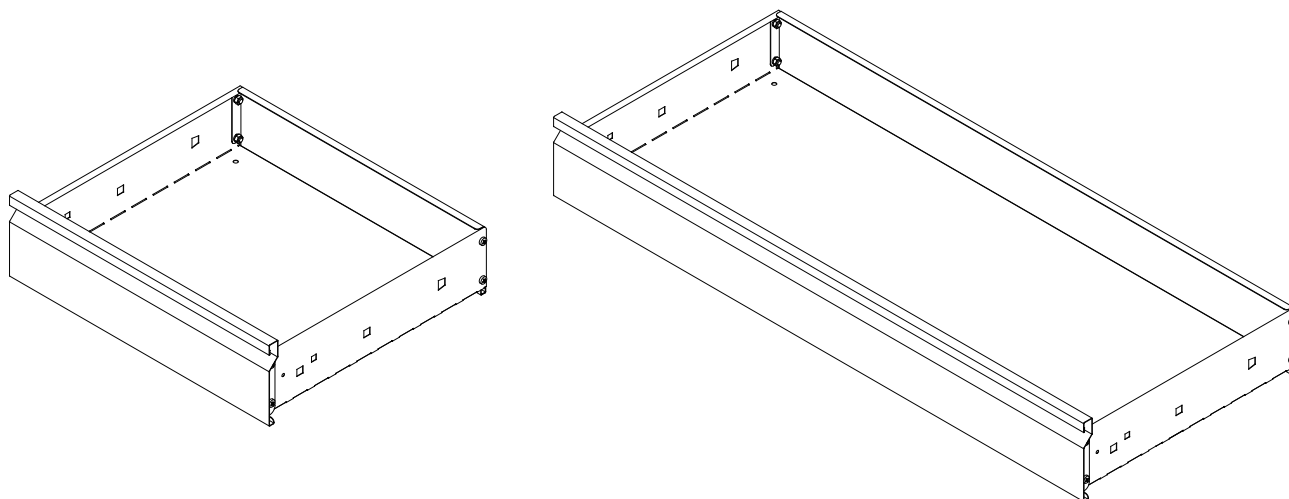

# Assembly BIGDUG® Garage Drawer Cabinet Workbench | GLWB123

- 4** Fit adjustable feet **P** to the left panel **B** and right panel **C**.

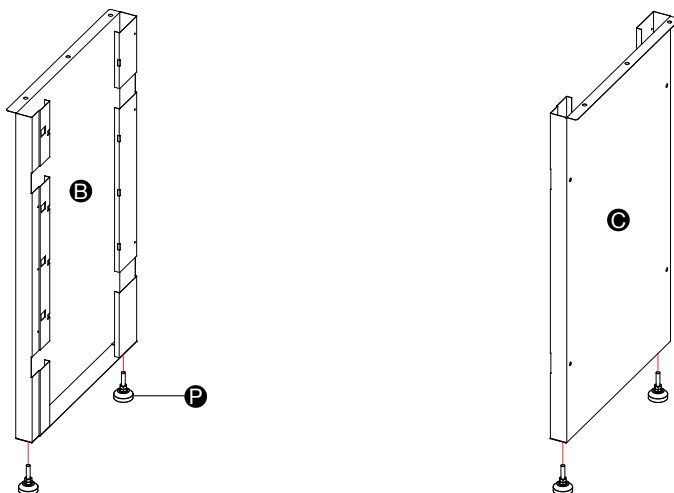

Please Note: Adjustable feet are for levelling purposes only and are not designed to raise the height of the worktop.

- 5** Fit center panels **D** to the base panel **E** and attach using fixing **R**, **T** and **U**.

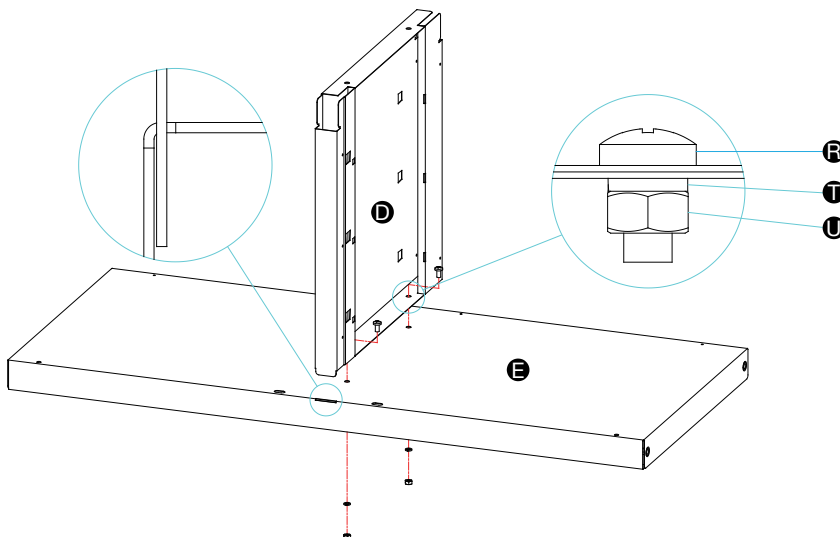

- 6** Insert panel **E** and cross beaming **G** into the left panel and secure using fixings **R**. Repeat the process on the right panel.

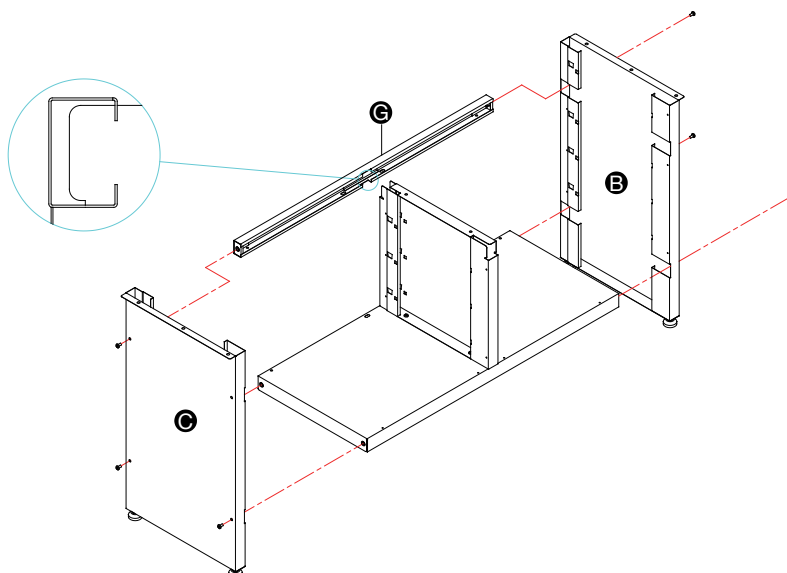

# Assembly **BIGDUG**® Garage Drawer Cabinet Workbench | GLWB123

**7** Fit rear panels **F** using fixings **Q**.

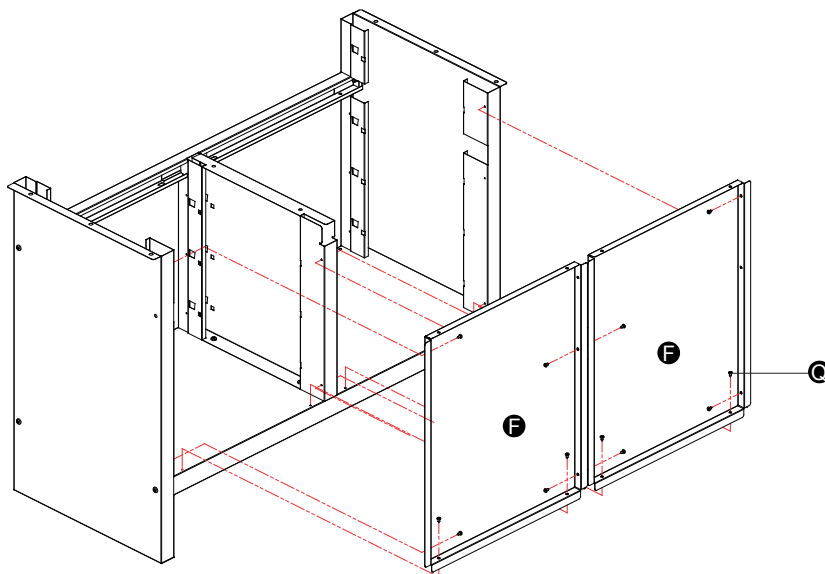

**8** Fit the rear section of each runner **N** + **O** to the side panel and center panel as shown.

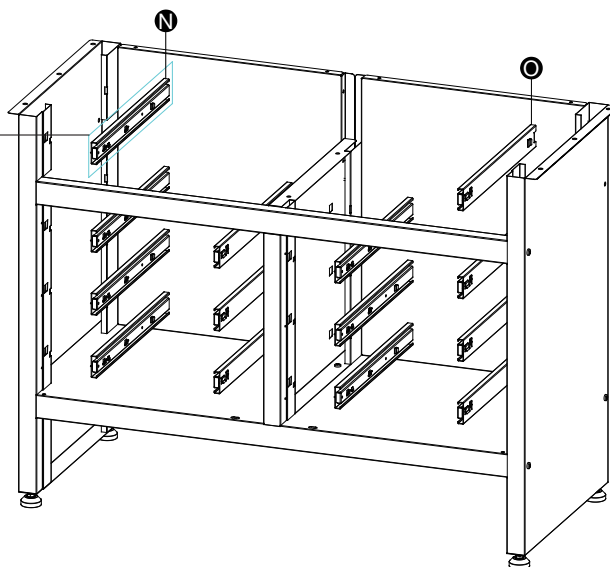
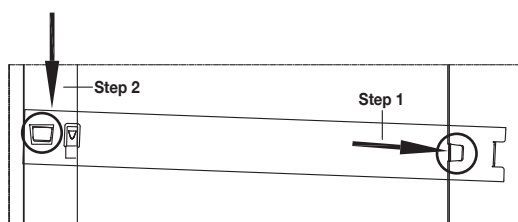

**9** Attach the worktop **A** using fixings **R**.

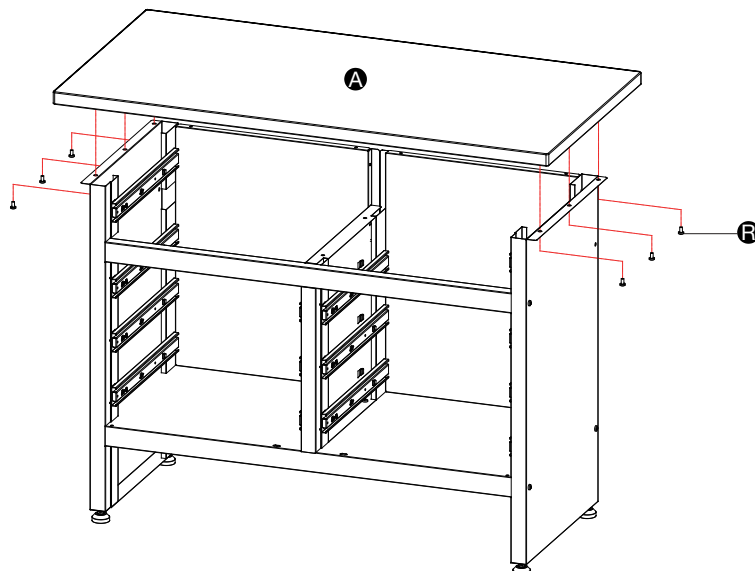

# Assembly **BIGDUG®** Garage Drawer Cabinet Workbench | GLWB123

**10** Attach the drawers as shown.

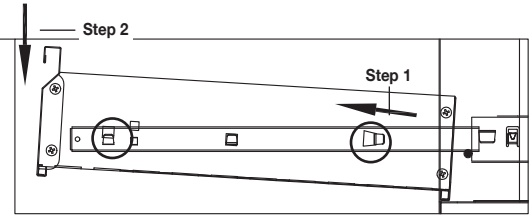
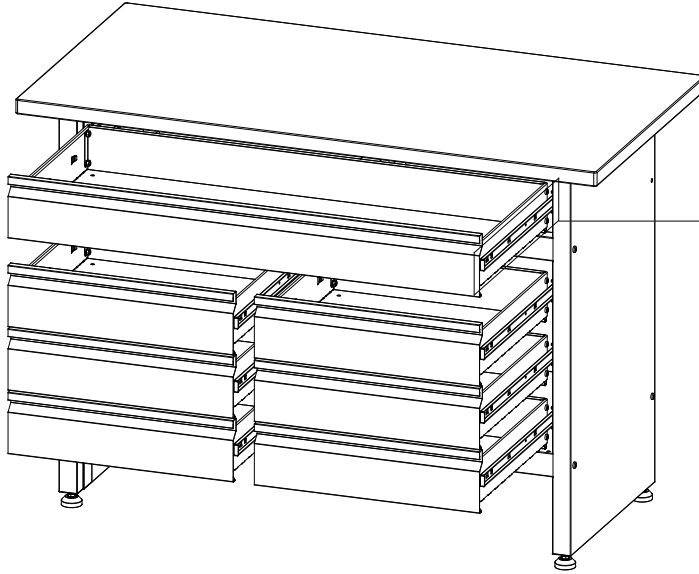

**11**

