



# Guide to Assembly & Usage

## BiGDUG Essentials Heavy-Duty Shelving

### Information

If in doubt, contact the supplier

 Read this guide thoroughly before commencing assembly and retain for future reference

 Before commencing assembly, unpack carefully and check that all components ordered are included

 Assembly should be undertaken by a minimum of two competent people

 **Tools:** Small rubber mallet and flat head screwdriver

 Assess for floor fixing. Tall narrow bays may require this to ensure stability

 We recommend products over 2000mm high are fixed to the wall where possible

### Caution

During assembly, ensure to:

 Take care during assembly and in use, particularly when lifting or stretching & when using tools

 Wear appropriate safety clothing – protective gloves and footwear are recommended

 Build on a suitable level floor, which is strong enough to support the load and allow adequate working space

 Dispose of packaging materials responsibly

### Warning

Rules for the safe use of shelving:

 Ensure these instructions are retained for reference and that users are aware of the rules for safe use

 Never climb on the structure or stand on the shelving

 Do not lean or support ladders, steps, or other objects against shelving

 Always use safety steps to reach high shelves

 Do not use in damp or wet conditions

 Load heavy items on the lower shelves & lighter items on the higher shelves

 This product is designed for hand loading only

 Ensure that the maximum load carrying capacities are not exceeded

 Please refer to the loading information supplied for details



### COMPONENT CHECK LIST

Component	Quantity
<b>A Upright</b>	4 per bay
<b>B Front &amp; Back Beam</b>	8 per bay
<b>C Side Beam</b>	8 per bay
<b>D Centre Support</b>	16 per bay*
<b>E MDF Board</b>	4 per bay
<b>F Foot</b>	4 per bay

\*8 Centre Supports per bay for 900 and 1200mm wide bays

### Loading information

#### Shelf load capacities

Maximum permitted shelf capacities are based on UDL†. Please note that the bay capacity may limit the maximum load per shelf.

BiGDUG Essentials Heavy-Duty Shelving		
Beam width mm	Load capacity per shelf	Maximum load per bay
900 mm	600kg	2400kg
1200 mm	600kg	2400kg
1600 mm	600kg	2400kg
1800 mm	500kg	2000kg
2000 mm	500kg	2000kg
2400 mm	450kg	1800kg

IF YOU ARE IN ANY DOUBT REGARDING LOAD CAPACITIES, PLEASE CONTACT YOUR SUPPLIER

†UDL = Uniformly Distributed Load

# BiGDUG Essentials Heavy-Duty Shelving

- 1** Place a Foot **F** onto the base of all Uprights **A**.

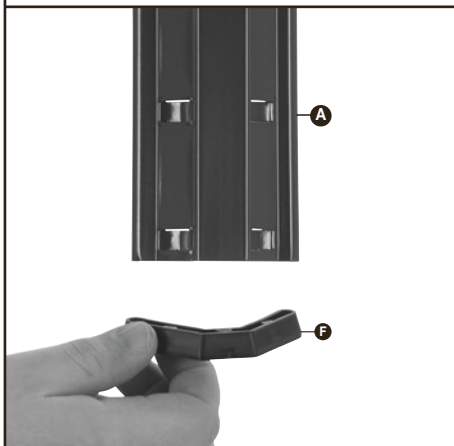

- 2** Insert tabs on a Side Beam **C** into an Upright **A** at a preferred height. Knock into place using a rubber mallet.

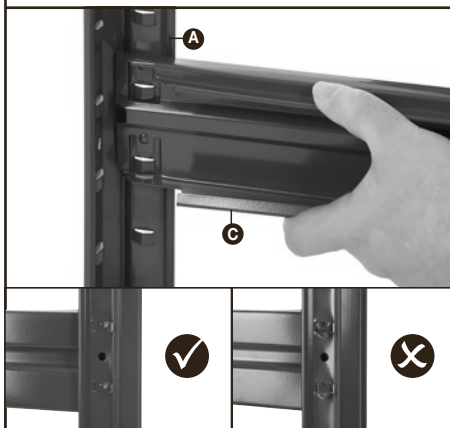

- 3** Repeat step two until you have created two "ladder like frames".



- 4** Join the two "ladder like frames" together using the longer Front & Back Beam **B**. Ensure all beams are positioned at the same height as the Side Beams **C**.



- 5** Add remaining Front & Back Beams **B** to the side frames to create the rest of the levels. Ensuring all beams are at the same height.



- 6** Insert 4\* Centre Supports **D** to each shelf level and simply twist to lock into place.  
\*2 Centre Supports per shelf for 900 and 1200mm wide bays.

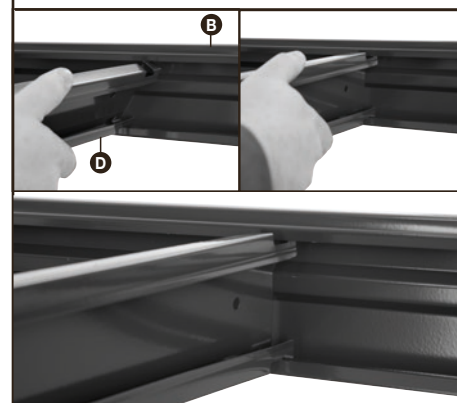

- 7** Centre Support **D** can be adjusted along shelf level to allow for heavy loads.



- 8** Add MDF Boards **E** onto each level to complete your shelving bay.



- 9** **ACCESSORIES ALSO AVAILABLE**

We recommend fixing to a wall for maximum stability.

