

**THANK YOU FOR PURCHASING A VAN GUARD TRADE VAN RACKING DROP DOWN DOOR**

**SUPPLIED COMPONENTS**

**AS3336 X1**  
(FIXING BRACKET - SINGLE - LEFT)



**AS3337 X1**  
(FIXING BRACKET - SINGLE - RIGHT)



**AS3339 X1**  
(FIXING BRACKET - DOUBLE - RIGHT)



**FX4011 X4**  
(M8 FLANGE NUT)



**FX4141 X4**  
(M8 X 16 COACH BOLT)



**FX4200 X2**  
(NYLON WASHER)



**TOOLS REQUIRED**

SPANNER (13MM / M8) X 1



ONE PERSON



FITTING TIME  
(APPROXIMATELY)

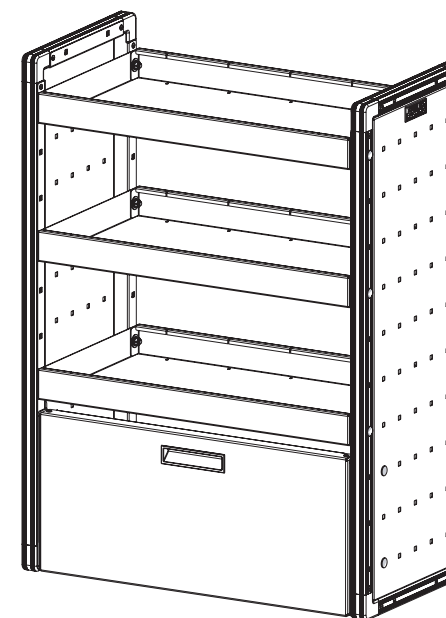

**RACKING UNIT NOT INCLUDED (PURCHASED SEPARATELY)**



## FIXING TO A SINGLE TRADE VAN RACKING UNIT (PAGE 1 OF 1)

The following page details how to fit the drop down door to a single racking unit. If you are fitting a drop down door to a double racking unit please see page 3. Position the spigots on the fixing brackets into the bottom slots of the drop down door with a nylon washer in between the bracket and the door. Secure the fixing brackets to the side panels using M8x16 coach bolts and M8 flange nuts. **Important - Racking side panels must be positioned with the labels facing as shown below.**

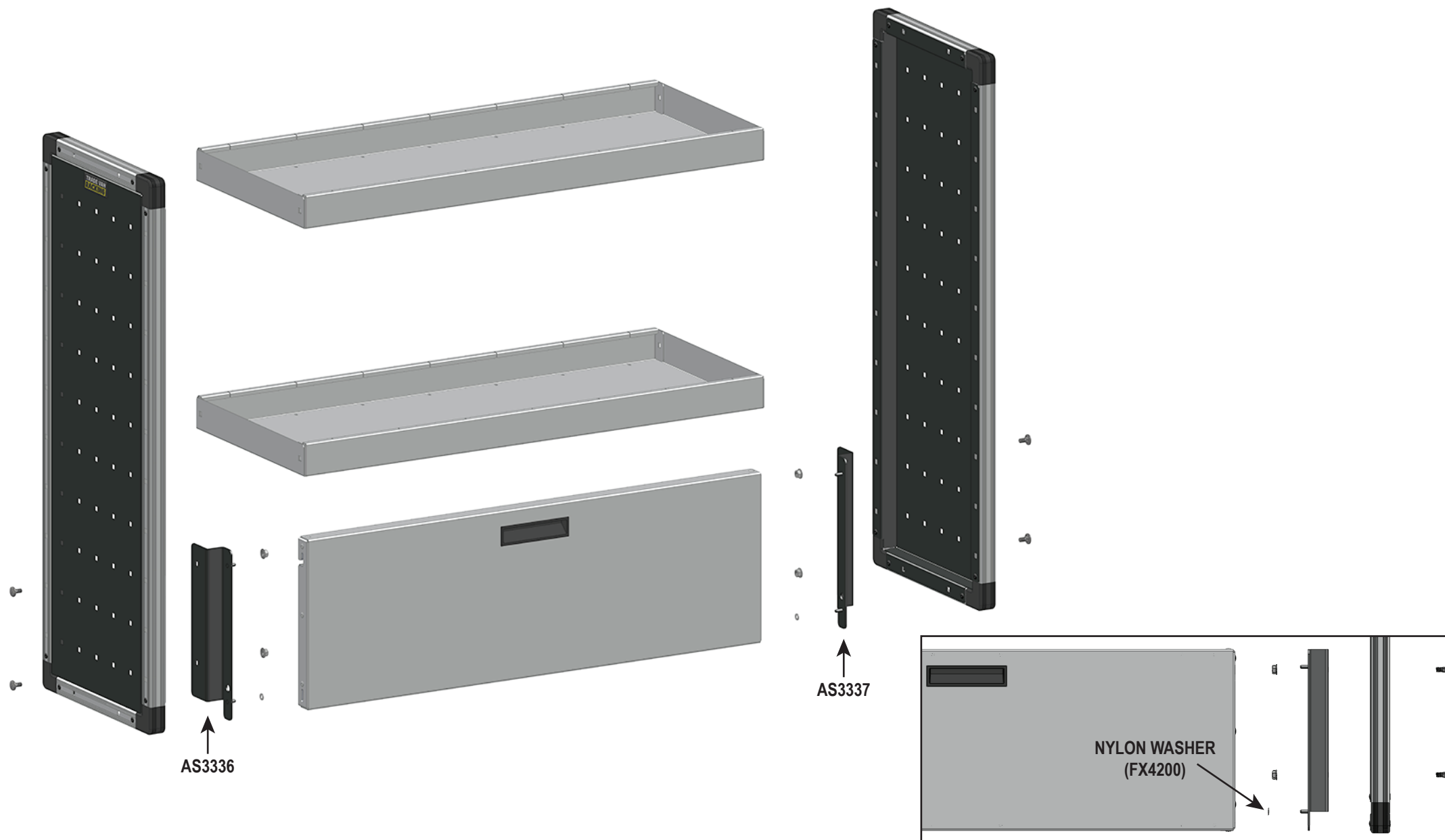



## FIXING TO A DOUBLE TRADE VAN RACKING UNIT (PAGE 1 OF 1)

The following page details how to fit the drop down door to a double racking unit. If you are fitting a drop down door to a single racking unit please see page 2. Position the spigots on the fixing brackets into the bottom slots of the drop down door with a nylon washer in between the bracket and the door. Secure the fixing brackets to the side panels using M8x16 coach bolts and M8 flange nuts. **Important - Racking side panels must be positioned with the labels facing as shown below.**

