

Guide to Assembly & Usage

Mecalux Longspan Shelving



Information

If in doubt, contact the supplier



Read this Guide thoroughly before commencing assembly & retain for future reference



Before commencing assembly, unpack carefully & check that all components ordered are included



Assembly should be undertaken by two competent people



Tools – Large rubber mallet, metal hammer, drill & 12mm drill bit, 17mm socket



Assess for floor fixing. Tall narrow bays may require this to ensure stability



We recommend products over 2000mm high are fixed to the wall where possible



Caution

During assembly, ensure to:



Take care during assembly & in use, particularly when lifting or stretching & when using tools



Wear appropriate safety clothing – protective gloves & footwear are recommended



Build on a suitable level floor, which is strong enough to support the load and allow adequate working space



Dispose of packaging materials responsibly



Warning

Rules for the safe use of shelving:



Ensure these instructions are retained for reference & that users are aware of the rules for safe use



NEVER CLIMB ON THE STRUCTURE OR STAND ON THE SHELVES



DO NOT LEAN OR SUPPORT LADDERS, STEPS, OR OTHER OBJECTS AGAINST SHELVING



Always use safety steps to reach high shelves



Do not use in damp or wet conditions



Load heavy items on the lower shelves & lighter items on the higher shelves



This product is designed for hand loading only



ENSURE THAT THE MAXIMUM LOAD CARRYING CAPACITIES ARE NOT EXCEEDED



PLEASE REFER TO THE LOADING CHART SUPPLIED FOR DETAILS



COMPONENT CHECK LIST

| Component | | Quantity |
|---------------------------|--|---|
| A Assembled Frame | | 2 per starter bay, 1 per extension bay |
| B Shelf Beam | | 2 per level |
| C Beam safety clip | | 2 per beam |
| D Chipboard deck | | Less than 1900mm wide: 1 per level 1900mm wide or greater: 2 per level |
| E Chipboard Clamp | | 2 per chipboard deck |
| F Levelling Plate | | 1 per foot |
| G Floor Fixing | | 1 per foot |

If you have any missing components please take note of the part name and contact your supplier

Assembly - Mecalux Longspan Shelving

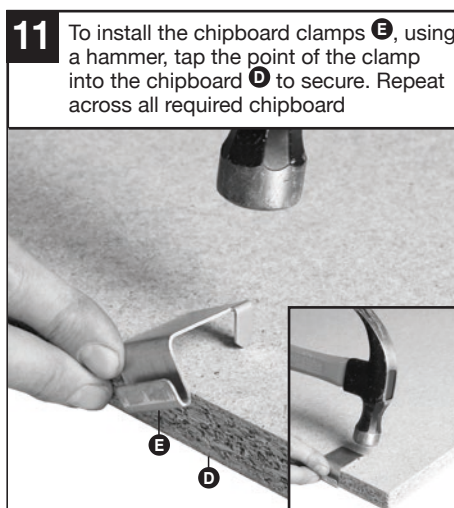
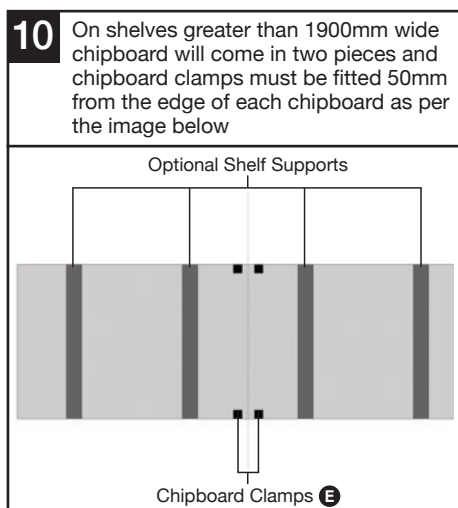
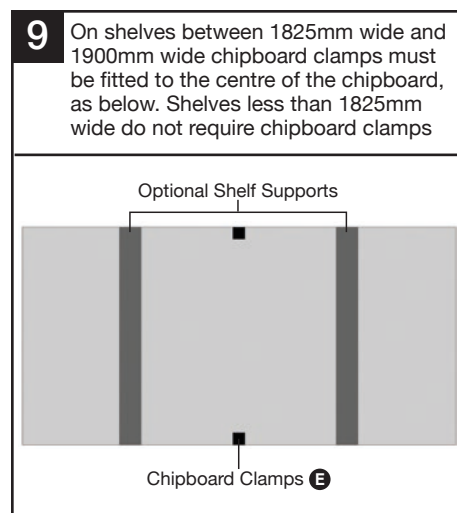
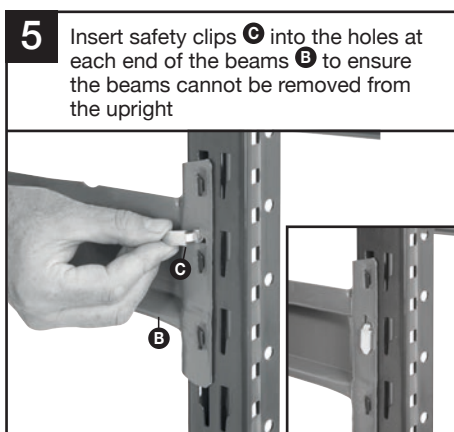
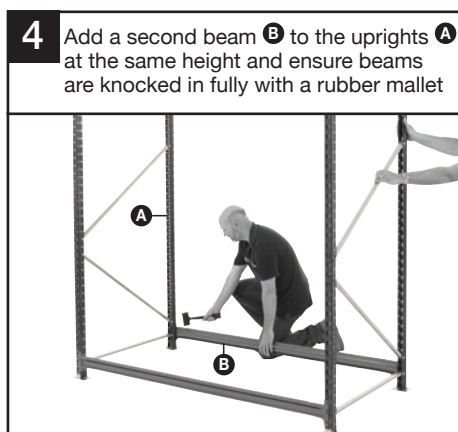
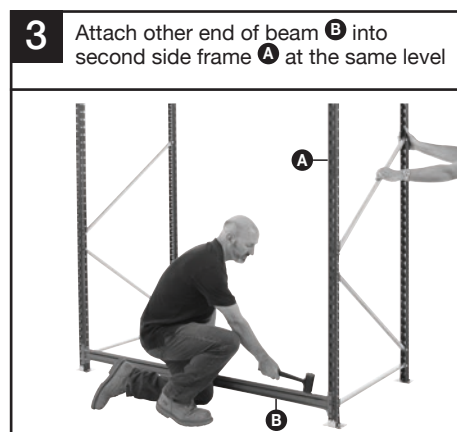
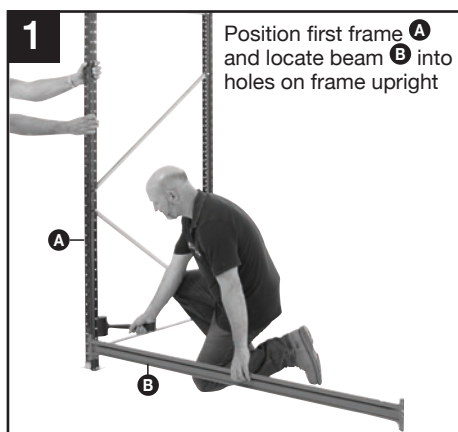

Note: Illustrations not to scale

Assembly – Mecalux Longspan Shelving

- 13** Before fixing to the floor, ensure shelving is straight and level. Drill floor to 100mm depth and add levelling plates **F** if needed

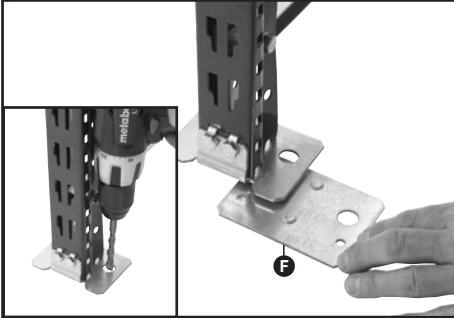

- 14** For optional galvanised steel shelves, insert each panel onto the beams **B** ensuring the lips hook over the edges as below

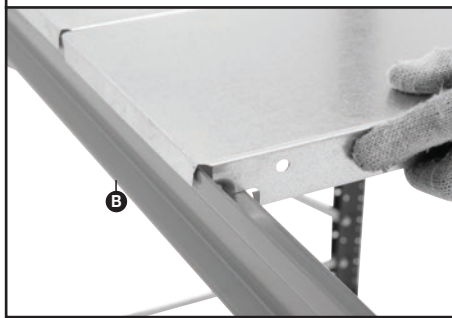

- 15** When inserting each panel ensure that wider panels are used at the ends of the shelves and narrower panels are used towards the centre



Loading information

Mecalux Longspan Shelving

Bay Loading Capacities

For maximum stability we recommend shelving runs consisting of a minimum 3 beam levels per bay and 3 bays in length. Fixing to the floor is also recommended, especially for taller frames or in areas of high traffic.

Load capacities will vary according to the clear height between each beam level as shown in the table below:

| Clear height between beams (mm) | 250 | 500 | 750 | 1000 | 1250 | 1500 | 1750 | 2000 | 2250 | 2500 |
|---------------------------------|------|------|------|------|------|------|------|------|------|------|
| Load capacity per frame (kg) | 4340 | 4060 | 3850 | 3600 | 3240 | 2800 | 2300 | 1920 | 1560 | 1320 |
| Load capacity per bay (kg) | 2170 | 2030 | 1925 | 1800 | 1620 | 1400 | 1150 | 960 | 780 | 660 |

For configurations outside of these specifications the load capacity may be reduced.

Shelf load capacities

Maximum permitted shelf capacities detailed below are based on uniformly distributed loads (UDL).

Please note that the frame capacity may limit the maximum load per bay.

| Shelf size (w x d mm) | 1200 x 600 | 1825 x 600 | 1900 x 600 | 2225 x 600 | 2300 x 600 | 2700 x 600 |
|--|------------|------------|------------|------------|------------|------------|
| Load capacity with 22mm Chipboard decks (kg) | 590 | 850 | 810 | 710 | 775 | 550 |
| Load capacity with Chipboard decks & 2 x Shelf Supports (kg) | 590 | 850 | 810 | 710 | 775 | 550 |
| Load capacity with galvanised steel shelf panels (kg) | 590 | 850 | 810 | 710 | 746 | 550 |

Shelf load capacities table continued:

| Shelf size (w x d mm) | 1200 x 900 | 1825 x 900 | 1900 x 900 | 2225 x 900 | 2300 x 900 | 2700 x 900 |
|--|------------|------------|------------|------------|------------|------------|
| Load capacity with 22mm Chipboard decks (kg) | 200 | 300 | 300 | 400 | 400 | 450 |
| Load capacity with Chipboard decks & 2 x Shelf Supports (kg) | 590 | 850 | 810 | 710 | 775 | 550 |
| Load capacity with galvanised steel shelf panels (kg) | 590 | 500 | 500 | 600 | 650 | 450 |

IF YOU ARE IN ANY DOUBT REGARDING LOAD CAPACITIES, PLEASE CONTACT YOUR SUPPLIER

[†]UDL = Uniformly Distributed Load